

REVISIONS			
REV	DESCRIPTION	DATE	APPROVED
0	INITIAL RELEASE	10/04/00	WR/DFG

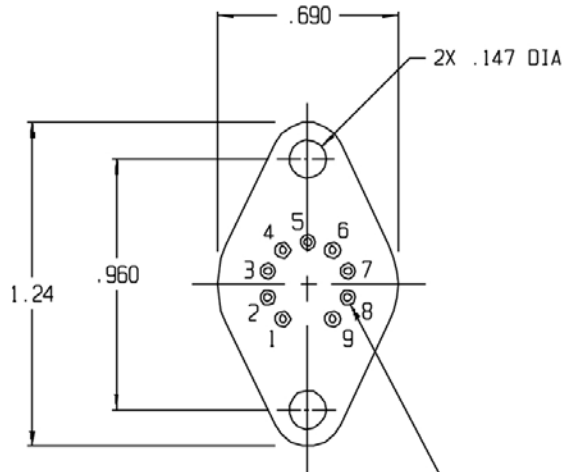
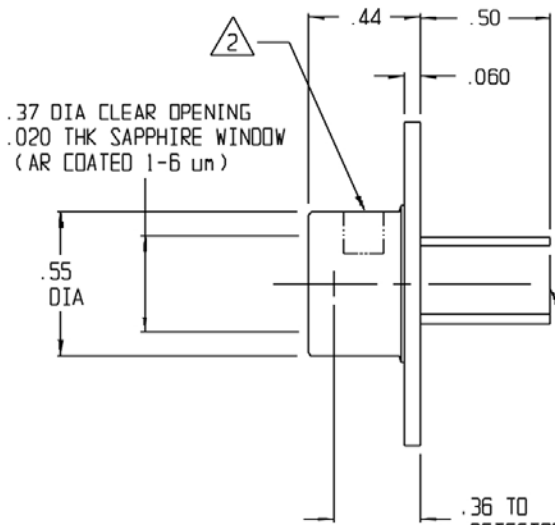

PIN CHART

PIN	FUNCTION	COLOR CODE
1	COOLER (+)	RED
2	N/C	CLEAR
3	N/C	
4	N/C	
5	THERMISTOR	YELLOW
6	THERMISTOR	
7	DETECTOR (+)	GREEN
8	DETECTOR (-)	WHITE
9	COOLER (-)	BLACK

BOTTOM VIEW

9X .030 DIA PINS ON  
.425 DIA B.C.  
SPACED 36° APART

- NOTES:
- PIN NUMBERS FOR REF ONLY.
  - PRODUCT MARKING.
  - MATES WITH P/N 300359 SOCKET, TO-66, 9-PIN.
  - SPECIFICATION FOR A THERMOELECTRICALLY COOLED HgCdTe DETECTOR

DETECTOR MATERIAL TYPE:	HgCdTe
ACTIVE AREA SIZE:	0.10 mm x 0.10 mm
DETECTOR SPECIFICATIONS AT:	-65 °C
MINIMUM D* (PEAK, 10Hz, 1Hz):	3.0E10 cmHz <sup>1/2</sup> W <sup>-1</sup>
MINIMUM RESPONSIVITY (PEAK, 900Hz):	20,000 V/W
MINIMUM WAVELENGTH CUTOFF:	50% AT 5.0 $\mu\text{m}$
WINDOW:	SAPPHIRE AR COATED 1-6 $\mu\text{m}$
DETECTOR PACKAGE:	TO-66

UNLESS OTHERWISE SPECIFIED: DIMENSIONS ARE IN INCHES: TOLERANCES		DRN K.F.M.	DATE 10/04/00
DECIMALS	ANGULAR	DESIGN K.F. MARSHALL	DATE 10/04/00
x ± .02	± 1/2°	CHECK FRANK CECI	DATE 10/04/2000
.xx ± .01		PROJECT N/A	DATE -----
.xxx ± .005		ENGR. APPROV. WILLIAM ROLLS	DATE 10/7/00
		QA APPROV. D.F. GREENE	DATE 10/9/00
NEXT ASSY	USED ON	THIRD ANGLE PROJECTION	

		221 COMMERCE DRIVE HUNT GEMERYVILLE, PA. USA 15936	
TITLE			
<b>J15TE3:5-66C-S100U</b>			
SIZE	DRG. NO.	REV	
<b>8</b>	<b>56586</b>	<b>450562P00</b>	<b>0</b>
SCALE	DO NOT SCALE DWG		SHEET 1 of 1
2:1			